

# THE MERGE - EASTVALE, CA

FOR LEASE - 10 UNITS - 19,315 SF - 90,723 SF

NEC of Limonite Ave. and Archibald Ave.



OWNED AND MANAGED BY:

*CLICK [HERE](#) TO VIEW PROPERTY HIGHLIGHTS VIDEO*

*[VISIT OUR WEBSITE](#)*



For Further Information Please Contact:

**Bill Heim**

bheim@lee-assoc.com

D 909.373.2901

License ID: 00776174

**Alex Heim**

aheim@lee-assoc.com

D 909.373.2701

Licence ID: 01945521

**Nesha Ritchie**

nritchie@lee-assoc.com

D 909.373.2942

Licence ID: 01936359

# THE MERGE - EASTVALE, CA

## FOR LEASE - 10 UNITS - 19,315 SF - 90,723 SF

NEC of Limonite Ave. and Archibald Ave.

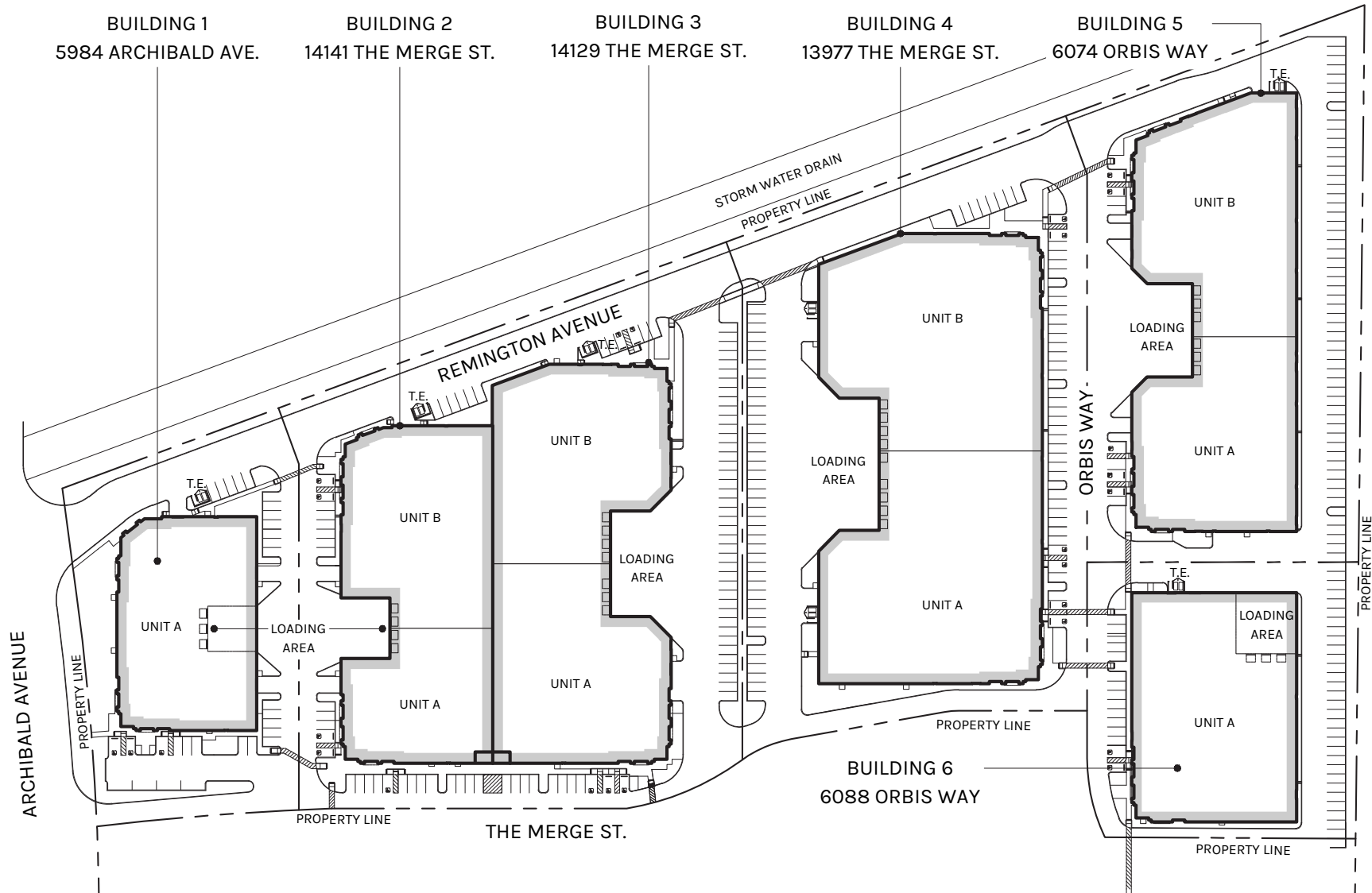



# THE MERGE - EASTVALE, CA

## FOR LEASE - 10 UNITS - 19,315 SF - 90,723 SF

NEC of Limonite Ave. and Archibald Ave.



### PROJECT FEATURES

- ESFR SPRINKLERS
- 800 AMPS 277/480, 3 PHASE 4 WIRE
- LED WAREHOUSE LIGHTING
- 2.5% SKYLIGHTS
- DELUXE OFFICE BUILD-OUT WITH FULLY FINISHED MEZZ OFFICE
- +/- 55 MILES TO PORTS OF LA AND LONG BEACH
- DIRECT ACCESS TO 1-15, SR 60, SR 71, & SR 91 FWYS
- IEW LOCATION WITH CLOSE PROXIMITY TO ONT

|              | ADDRESS            | UNIT SIZE | TOTAL BUILDING SF | 1ST FLOOR OFFICE SF | MEZZANINE OFFICE SF | DOCK HIGH DOORS | GROUND LEVEL DOORS | CLEAR HEIGHT | BROCHURE             |
|--------------|--------------------|-----------|-------------------|---------------------|---------------------|-----------------|--------------------|--------------|----------------------|
| BUILDING 1   | 5984 ARCHIBALD AVE | 29,460    | 29,460            | 1,525               | 1,497               | 3               | 2                  | 30'          | <a href="#">LINK</a> |
| BUILDING 2-A | 14141 THE MERGE ST | 19,315    | 48,461            | 1,525               | 1,497               | 2               | 1                  | 30'          | <a href="#">LINK</a> |
| BUILDING 2-B | 14141 THE MERGE ST | 29,146    | 48,461            | 1,557               | 1,401               | 2               | 1                  | 30'          | <a href="#">LINK</a> |
| BUILDING 3-A | 14129 THE MERGE ST | 32,037    | 63,853            | 1,525               | 1,497               | 3               | 1                  | 30'          | <a href="#">LINK</a> |
| BUILDING 3-B | 14129 THE MERGE ST | 31,816    | 63,853            | 1,525               | 1,497               | 4               | 1                  | 30'          | <a href="#">LINK</a> |
| BUILDING 4-A | 13977 THE MERGE ST | 46,694    | 90,723            | 1,846               | 1,937               | 5               | 1                  | 32'          | <a href="#">LINK</a> |
| BUILDING 4-B | 13977 THE MERGE ST | 44,029    | 90,723            | 1,850               | 1,939               | 4               | 1                  | 32'          | <a href="#">LINK</a> |
| BUILDING 5-A | 6074 ORBIS WAY     | 29,405    | 63,540            | 1,536               | 1,518               | 3               | 1                  | 30'          | <a href="#">LINK</a> |
| BUILDING 5-B | 6074 ORBIS WAY     | 34,135    | 63,540            | 1,557               | 1,401               | 3               | 1                  | 30'          | <a href="#">LINK</a> |
| BUILDING 6   | 6088 ORBIS WAY     | 37,507    | 37,507            | 1,547               | 1,519               | 3               | 1                  | 30'          | <a href="#">LINK</a> |

# THE MERGE - EASTVALE, CA

## FOR LEASE - 10 UNITS - 19,315 SF - 90,723 SF

NEC of Limonite Ave. and Archibald Ave.



For Further Information Please Contact:

**Bill Heim**

bheim@lee-assoc.com  
D 909.373.2901  
License ID: 00776174

**Alex Heim**

aheim@lee-assoc.com  
D 909.373.2701  
Licence ID: 01945521

**Nesha Ritchie**

nritchie@lee-assoc.com  
D 909.373.2942  
Licence ID: 01936359

